

The MOTOMAN MH5S, MH5F and MH5LS, MH5LF are compact, high-speed 6-axis robots that offer superior performance in a variety of applications such as packaging, material handling, machine tending and dispensing, where versatility is required. The MH5S, MH5F and MH5LS, MH5LF feature high reach and offer the widest work envelope in its class. Its compact design and built-in collision detection feature with multiple robot control allow up to eight robots to be used together to optimize productivity. This all-round robots can be driven by the high-performance-controller DX100 as well as the compact-controller FS100.



Key benefits

- Compact, powerful and economical
- Compact design allows maximum performance using minimal floor space
- Yields extraordinary production results while requiring minimal capital investment
- Internally routed cables and hoses maximize system reliability

MOTOMAN MH5S, MH5F MOTOMAN MH5LS, MH5LF

General purpose and handling



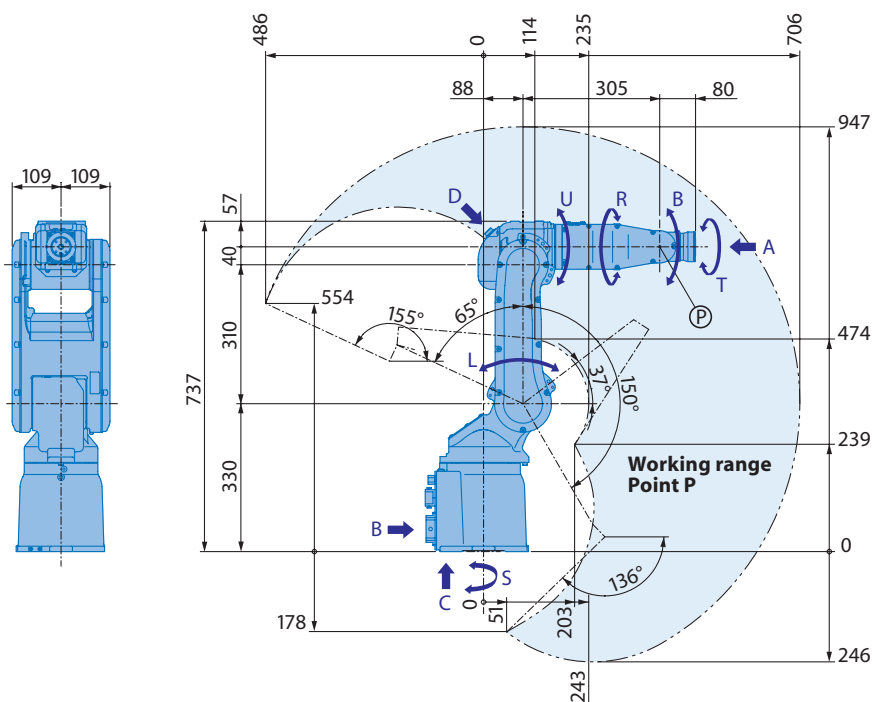

View A

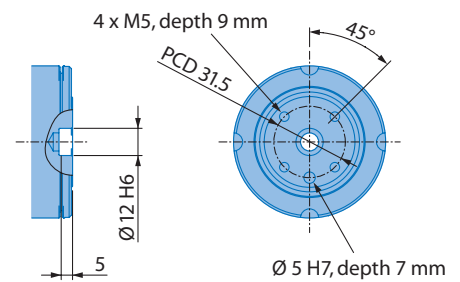

View B

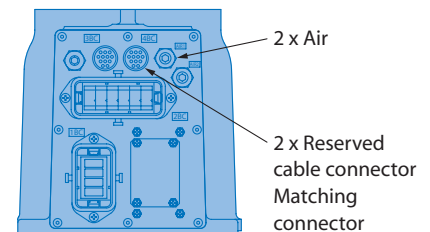

View C

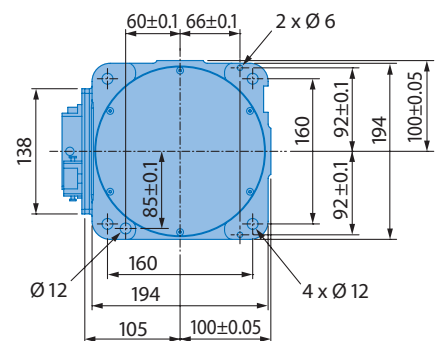

Mounting options: Floor, ceiling, wall

View D

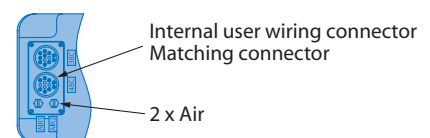

All dimensions in mm | Technical data may be subject to change without previous notice | Please request detailed drawings at robotics@yaskawa.eu.com – YR-MH0005S-A12 (DX100), YR-MH0005F-A12 (FX100), B-07-2012, A-No. 150257

Allowable wrist load

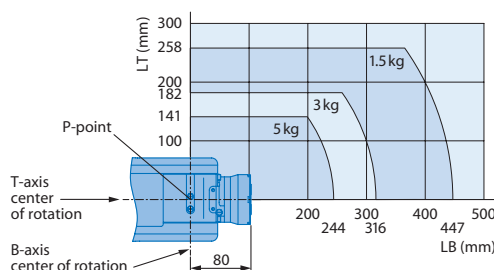

Specifications MH5S, MH5F

| Axes | Maximum motion range [°] | Maximum speed [°/sec.] | Allowable moment [Nm] | Allowable moment of inertia [kg · m ²] | Controlled axes | |
|------|--------------------------|------------------------|-----------------------|--|-----------------------------|----------|
| S | ±170 | 376 | – | – | Max. payload [kg] | 5 |
| L | +150/–65 | 350 | – | – | Repeat. pos. accuracy [mm] | ±0.02 |
| U | +155/–136 | 400 | – | – | Max. working range [mm] | R = 706 |
| R | ±190 | 450 | 12 | 0.3 | Temperature [°C] | 0 to +45 |
| B | ±135 | 450 | 12 | 0.3 | Humidity [%] | 20 – 80 |
| T | ±360 | 720 | 7 | 0.1 | Weight [kg] | 27 |
| | | | | | Power supply, average [KVA] | 1 |

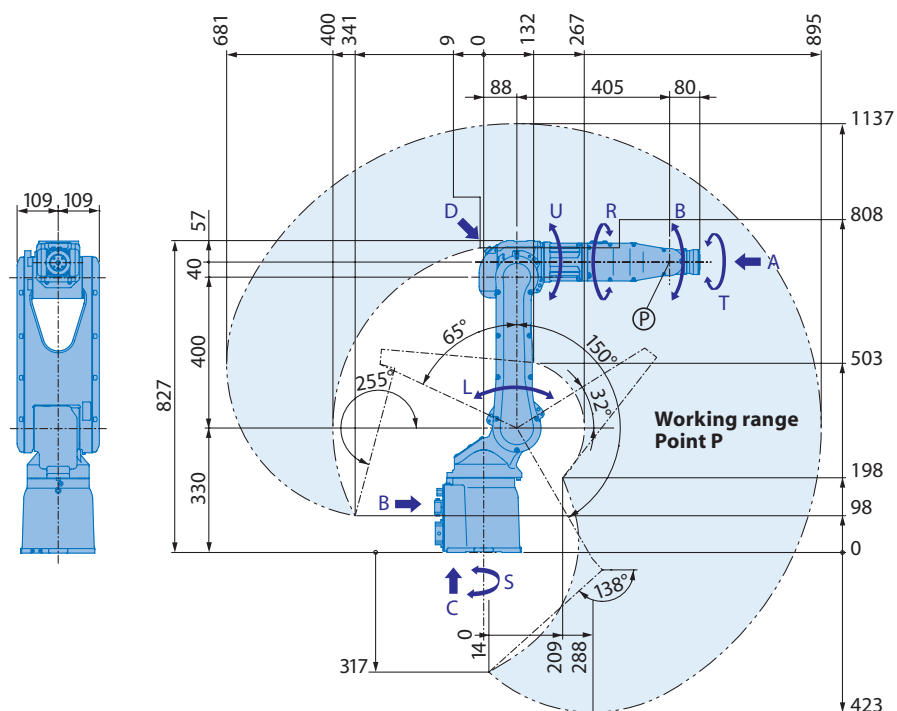

View A

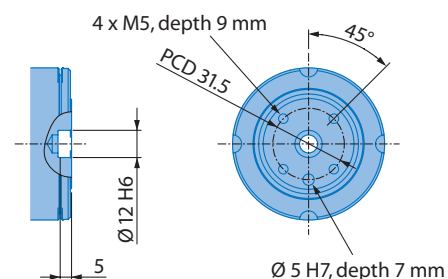

View B

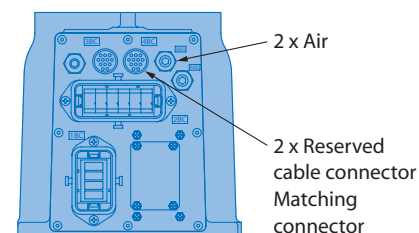

View C

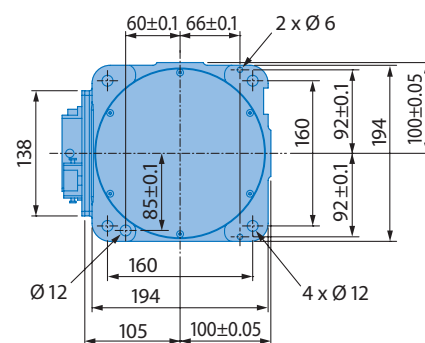

Mounting options: Floor, ceiling, wall

View D

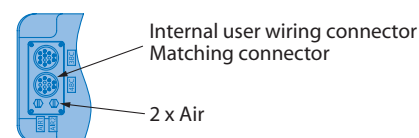

All dimensions in mm | Technical data may be subject to change without previous notice | Please request detailed drawings at robotics@yaskawa.eu.com – YR-MH0005LS-A12 (DX100), YR-MH005LF-A12 (FX100), B-07-2012, A-No. 150259

Allowable wrist load

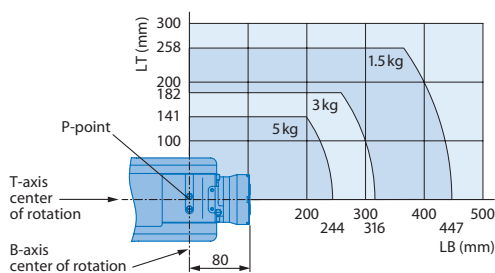

Specifications MH5LS, MH5LF

| Axes | Maximum motion range [°] | Maximum speed [°/sec.] | Allowable moment [Nm] | Allowable moment of inertia [kg · m ²] | Controlled axes | |
|------|--------------------------|------------------------|-----------------------|--|-----------------------------|----------|
| S | ±170 | 270 | – | – | Max. payload [kg] | 5 |
| L | +150/–65 | 280 | – | – | Repeat. pos. accuracy [mm] | ±0.03 |
| U | +255/–138 | 300 | – | – | Max. working range [mm] | R = 895 |
| R | ±190 | 450 | 12 | 0.3 | Temperature [°C] | 0 to +45 |
| B | ±135 | 450 | 12 | 0.3 | Humidity [%] | 20 – 80 |
| T | ±360 | 720 | 7 | 0.1 | Weight [kg] | 29 |
| | | | | | Power supply, average [KVA] | 1 |

YASKAWA contacts

YASKAWA Headquarters

YASKAWA Europe GmbH
Robotics Division
Yaskawastraße 1
D-85391 Allershausen
Tel. +49 (0) 8166/90-0
Fax +49 (0) 8166/90-103

YASKAWA Academy and sales office Frankfurt

YASKAWA Europe GmbH
Robotics Division
Hauptstraße 185
D-65760 Eschborn
Tel. +49 (0) 6196/77725-0
Fax +49 (0) 6196/77725-39

YASKAWA Group

- A YASKAWA Austria
Schwechat/Wien +43(0)1-707-9324-15
- CZ YASKAWA Czech s.r.o.
Rudná u Prahy +420-257-941-718
- E YASKAWA Ibérica, S.L.
Gavà/Barcelona +34-93-6303478
- F YASKAWA France SARL
Saint-Aignan-de-Grand-Lieu
+33-2-40131919
- FIN YASKAWA Finland Oy
Turku +358-(0)-403000600
- GB YASKAWA UK Ltd.
Banbury +44-1295-272755
- I YASKAWA Italia s.r.l.
Torino +39-011-9005833
- IL YASKAWA Europe Technology Ltd.
Rosh Ha'ayin +972-3-9004114
- NL YASKAWA Benelux B.V.
EB Son +31-40-2895500
- RUS YASKAWA Nordic AB
Moskva +46-480-417-800
- SE YASKAWA Nordic AB
Torsås +46-480-417-800
- SI YASKAWA Slovenia
Ribnica +386-1-8372-410
- TR YASKAWA Türkiye
Şerifali Mah. Barbaros Cad. No: 24
Ümraniye, İstanbul +90-216-5273450
- ZA YASKAWA Southern Africa (PTY) Ltd
Johannesburg +27-11-6083182

Distributors

- BG Kammarton Bulgaria Ltd.
Sofia +359-02-926-6060
- CH Messer Eutectic Castolin Switzerland S.A.
Dällikon +41-44-847-17-17
- DK Robotcenter Danmark
Løsning +45 7022 2477
- EE RKR Seadmed OÜ
Tallinn/Estonia +372-68-35-235
- GR Gizelis Robotics
Nea Kifissia +30-2106251455
- H Flexman Robotics Kft
Budapest +36-30-9510065
- LT Profibus UAB
Panevezys +370-45-518575
- N Optimove as
Lierstranda +47-32240600
- PL Integrator RHC Sp. z o.o.
Torun +48-56-6519710
- RO Sam Robotics srl
Timisoara +40-720-279-866



www.yaskawa.eu.com
robotics@yaskawa.eu.com

Technical data may be subject to change without previous notice.

