

The MOTOMAN MH5S II, MH5F and MH5LS II, MH5LF are compact, high speed 6-axis robots that offer superior performance in a variety of applications such as packaging, material handling, machine tending and dispensing, where versatility is required. The MH5S II, MH5F and MH5LS II, MH5LF feature high reach and offer the widest work envelope in its class. Its compact design and built-in collision detection feature with multiple robot control allow up to eight robots to be used together to optimize productivity. This all-round robots can be driven by the high-performance-controller DX200 as well as the compact-controller FS100.

Controlled by  
**DX200**

Controlled by  
**FS100**



### Key benefits

- Compact, powerful and economical
- Compact design allows maximum performance using minimal floor space
- Yields extraordinary production results while requiring minimal capital investment
- Internally routed cables and hoses maximize system reliability

## MOTOMAN MH5S II, MH5F MOTOMAN MH5LS II, MH5LF

General purpose and handling



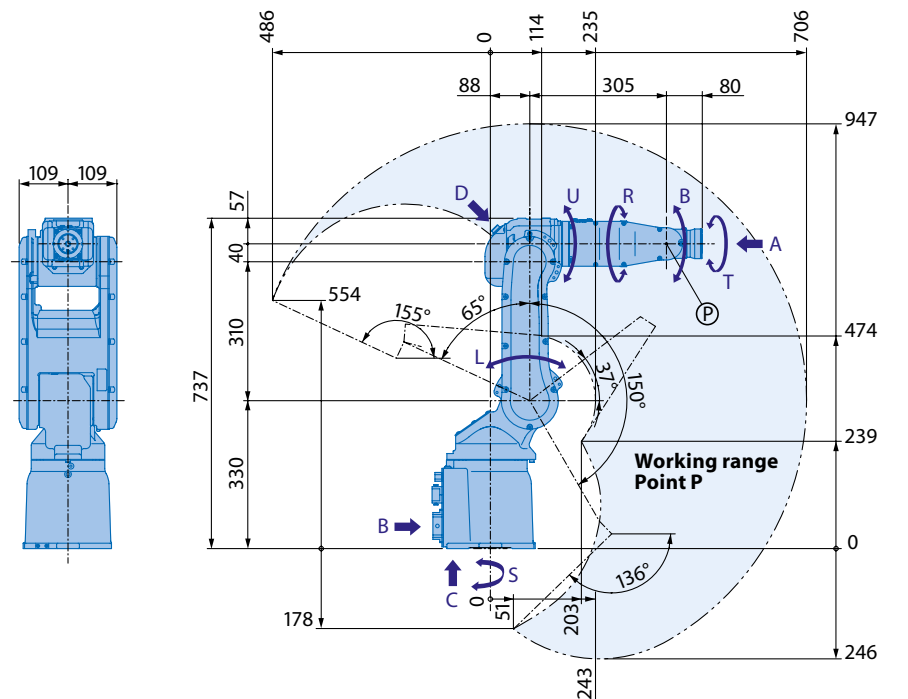

View A

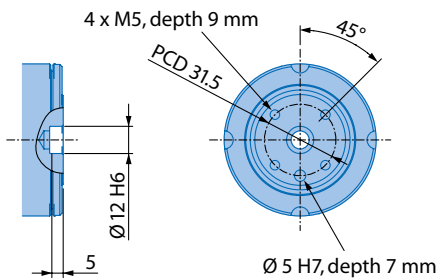

View B

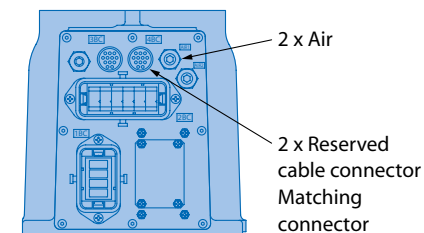

View C

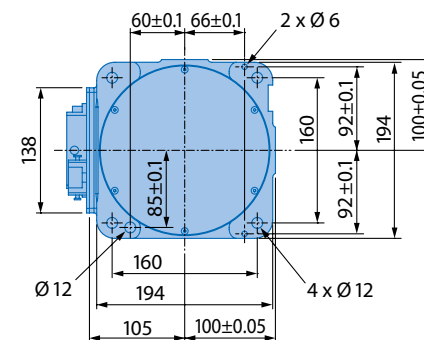

Mounting options: Floor, ceiling, wall

View D

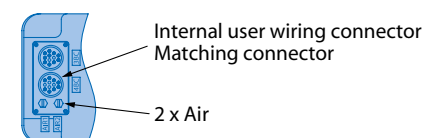

All dimensions in mm | Technical data may be subject to change without previous notice | Please request detailed drawings at robotics@yaskawa.eu.com – YR-MH0005SII-J00 (DX200), YR-MH0005F-A12 (FS100), A-04-2014, A-No. 167079

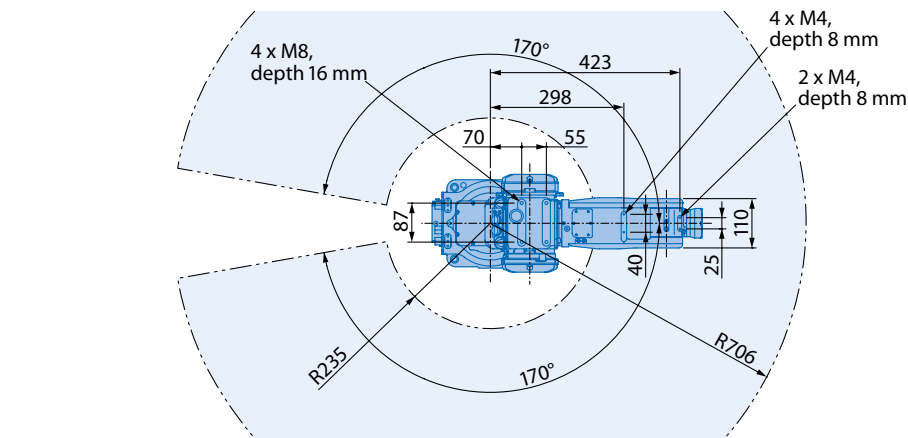

Allowable wrist load

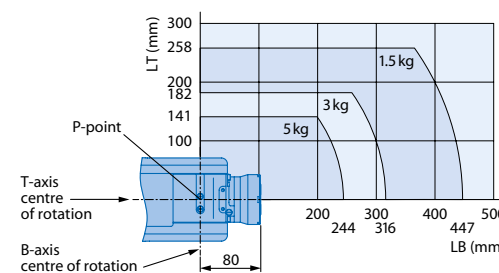

## Specifications MH5S II, MH5F

Axes	Maximum motion range [°]	Maximum speed [°/sec.]	Allowable moment [Nm]	Allowable moment of inertia [kg · m <sup>2</sup> ]	Controlled axes	
S	±170	376	–	–	Max. payload [kg]	5
L	+150/–65	350	–	–	Repeat. pos. accuracy [mm]	±0.02
U	+155/–136	400	–	–	Max. working range [mm]	R = 706
R	±190	450	12	0.3	Temperature [°C]	0 to +45
B	±135	450	12	0.3	Humidity [%]	20 – 80
T	±360	720	7	0.1	Weight [kg]	27
					Power supply, average [KVA]	1

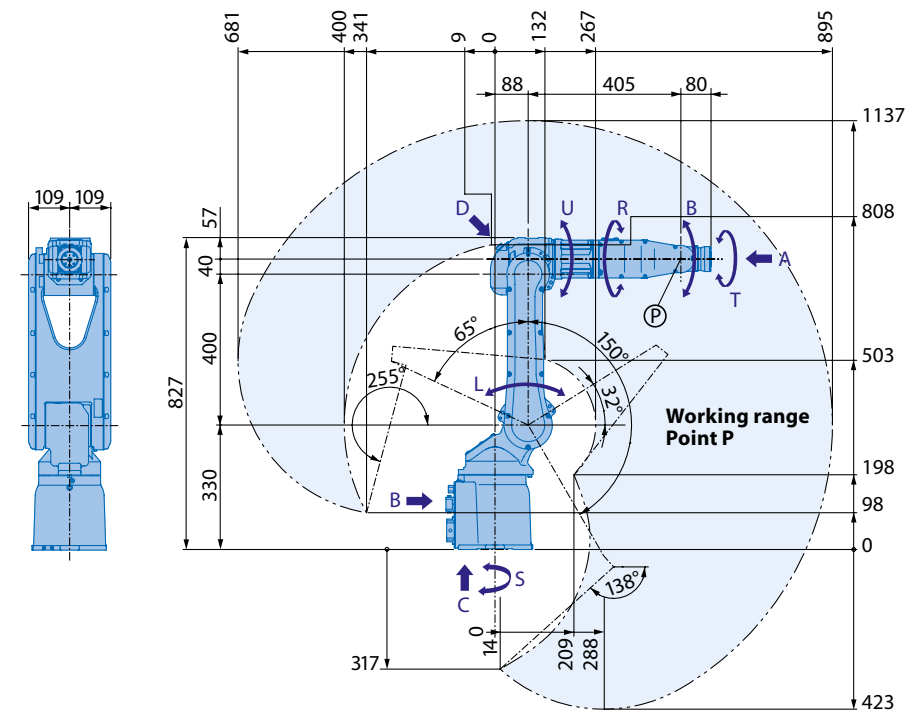

View A

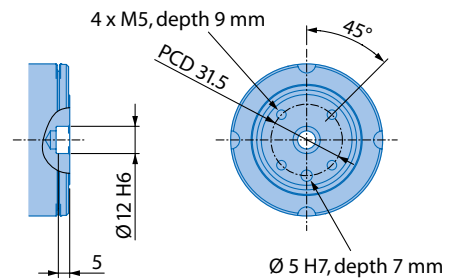

View B

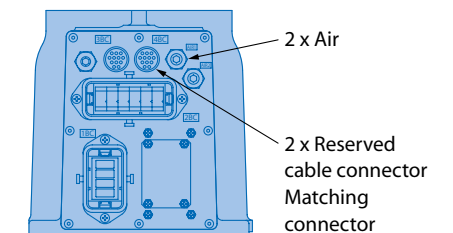

View C

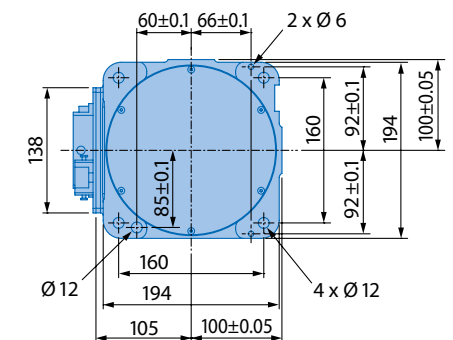

Mounting options: Floor, ceiling, wall

View D

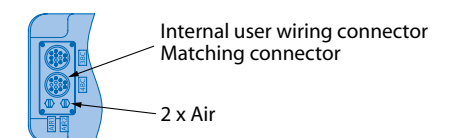

All dimensions in mm | Technical data may be subject to change without previous notice | Please request detailed drawings at robotics@yaskawa.eu.com – YR-MH0005LSII-J00 (DX200), YR-MH005LF-A12 (FS100), A-04-2014, A-No. 167079

Allowable wrist load

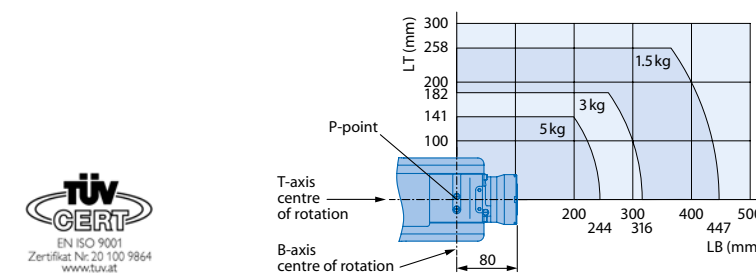

## Specifications MH5LS II, MH5LF

Axes	Maximum motion range [°]	Maximum speed [°/sec.]	Allowable moment [Nm]	Allowable moment of inertia [kg · m <sup>2</sup> ]	Controlled axes	
S	±170	270	–	–	Max. payload [kg]	5
L	+150/–65	280	–	–	Repeat. pos. accuracy [mm]	±0.03
U	+255/–138	300	–	–	Max. working range [mm]	R = 895
R	±190	450	12	0.3	Temperature [°C]	0 to +45
B	±135	450	12	0.3	Humidity [%]	20 – 80
T	±360	720	7	0.1	Weight [kg]	29
					Power supply, average [KVA]	1

## YASKAWA Headquarters

YASKAWA Europe GmbH  
Robotics Division  
Yaskawastraße 1  
D-85391 Allershausen  
Tel. +49 (0) 8166/90-0  
Fax +49 (0) 8166/90-103

## YASKAWA academy and sales office Frankfurt

YASKAWA Europe GmbH  
Robotics Division  
Hauptstraße 185  
D-65760 Eschborn  
Tel. +49 (0) 6196/77725-0  
Fax +49 (0) 6196/77725-39

## YASKAWA Group

- A YASKAWA Austria  
Schwechat/Wien +43(0)1-707-9324-15
- CZ YASKAWA Czech s.r.o.  
Rudná u Prahy +420-257-941-718
- E YASKAWA Ibérica, S.L.  
Gavà/Barcelona +34-93-6303478
- F YASKAWA France SARL  
Saint-Aignan-de-Grand-Lieu  
+33-2-40131919
- FIN YASKAWA Finland Oy  
Turku +358-(0)-403000600
- GB YASKAWA UK Ltd.  
Banbury +44-1295-272755
- I YASKAWA Italia s.r.l.  
Torino +39-011-9005833
- IL YASKAWA Europe Technology Ltd.  
Rosh Ha'ayin +972-3-9004114
- NL YASKAWA Benelux B.V.  
EB Son +31-40-2895500
- RUS YASKAWA Nordic AB  
Moskva +46-480-417-800
- SE YASKAWA Nordic AB  
Torsås +46-480-417-800
- SI YASKAWA Slovenia  
Ribnica +386-1-8372-410
- TR YASKAWA Turkey Elektrik Ticaret Ltd. Sti.  
İstanbul +90-216-5273450
- ZA YASKAWA Southern Africa (PTY) Ltd  
Johannesburg +27-11-6083182

## Distributors

- BG Kammarton Bulgaria Ltd.  
Sofia +359-02-926-6060
- CH Messer Eutectic Castolin Switzerland S.A.  
Dällikon +41-44-847-17-17
- DK Robotcenter Danmark  
Løsning +45 7022 2477
- EE RKR Seadmed OÜ  
Tallinn/Estonia +372-68-35-235
- GR Gizelis Robotics  
Nea Kifissia +30-2106251455
- H Flexman Robotics Kft  
Budapest +36-30-9510065
- LT Profibus UAB  
Panevezys +370-45-518575
- N Optimove as  
Lierstranda +47-32240600
- PL Integrator RHC Sp. z o.o.  
Torun +48-56-6519710
- PT ROBOPLAN Lda  
Aveiro +351-234 943 900
- RO Sam Robotics srl  
Timisoara +40-720-279-866
- RO MPL Automation S.R.L.  
Satu Mare +40 (0) 261 750 741



[www.yaskawa.eu.com](http://www.yaskawa.eu.com)  
[robotics@yaskawa.eu.com](mailto:robotics@yaskawa.eu.com)

Technical data may be subject to change without previous notice.